

ACCU-TELL® SARS-COV-2 ANTIGEN RAPID TEST

- For Nasopharyngeal Swab Samples;
- High Sensitivity, Specificity, and Accuracy compared with RT-PCR;
- 10 minutes to read the results

[View More](#)



CATALOG

Product Name	Specimen	Catalog No.	Quantity per pack	Certificate
SARS-CoV-2 Ag Cassette	Nasopharyngeal Swab	ABT-IDT-B367	20 tests	CE

TEST PROCEDURE

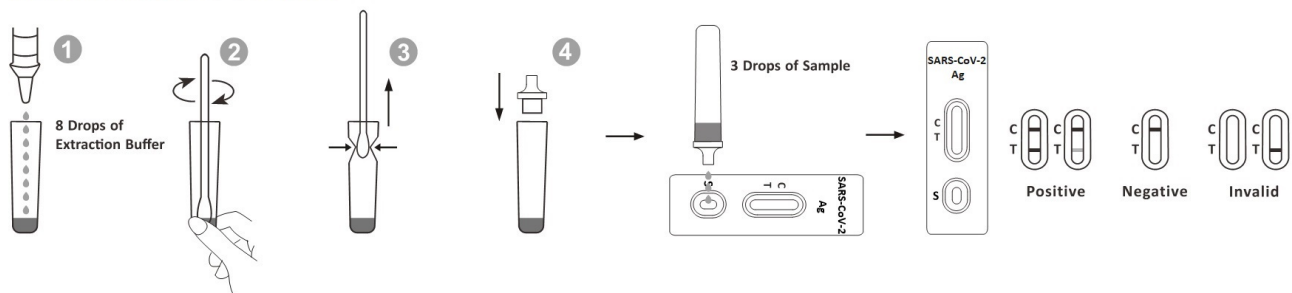

PERFORMANCE CHARACTERISTICS

Sensitivity, Specificity and Accuracy

ACCU-TELL® SARS-CoV-2 Ag Cassette (Nasopharyngeal Swab) has been evaluated with specimens obtained from the patients. RT-PCR is used as the reference method for ACCU-TELL® SARS-CoV-2 Ag Cassette (Nasopharyngeal Swab). Specimens were considered positive if PCR indicated a positive result.

Method	RT-PCR			Total Results
	Results	Positive	Negative	
ACCU-TELL® SARS-CoV-2 Ag Cassette (Nasopharyngeal Swab)	Positive	38	3	41
	Negative	2	360	362
Total Results		40	363	403

Relative Sensitivity: 95.0% (95%CI*:83.1%-99.4%)*

Relative Specificity: 99.2% (95%CI*:97.6%-99.8%)*

Relative accuracy: 98.8% (95%CI*:97.1%-99.6%)*

* Confidence Intervals

Detection Limit

The LOD for ACCU-TELL® SARS-CoV-2 Ag Cassette (Nasopharyngeal Swab) was established using limiting dilutions of a viral sample inactivated. The material (ZeptoMetrix, 0810587CFHI) was supplied at a concentration of 1.15×10^7 TCID₅₀/mL. The Estimated LOD is 1000 TCID₅₀/mL.

MATERIALS PROVIDED

- ✓ Test cassettes
- ✓ Extraction Reagent
- ✓ Extraction Tubes
- ✓ Dropper tips
- ✓ Sterile Swabs
- ✓ Package Insert
- ✓ Workstation



AccuBioTech Co., Ltd.
Accurate, Reliable, Cost Effective