

Capilia™ Strep A Operation Guide

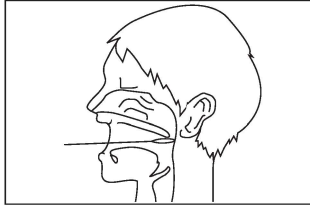

Method of Specimen Collection

Pharyngeal swab



Collect specimen with a pharyngeal swab.

Reagent 1 : sodium nitrite solution [Color of reagent : Pink]

Reagent 2 : acetic acid solution [Colorless]

Extraction reagent : Add 5 drops of Reagent 2 to Reagent 1 [Light yellow]

Sample Preparation

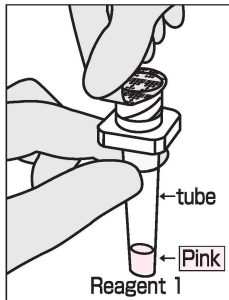

Remove the aluminum sealing cap from the tube of Reagent 1 (sodium nitrite solution), while taking care not to spill the liquid.

Color of reagent : Pink

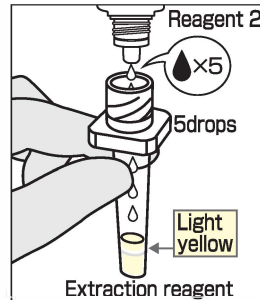

Remove the cap from the bottle of Reagent 2 (acetic acid solution), and hold the bottle perpendicularly with the tip down. Add 5 drops of Reagent 2 to Reagent 1, and use this as the extractive reagent.

Color of reagent : Changed to light yellow

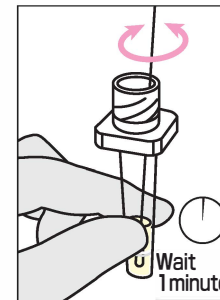

Soak the swab in the extraction reagent, stir well and allow to stand for 1 minute. Then, pinch the tip of the swab firmly with your fingers and squeeze out the swab.

Wait 1 minute

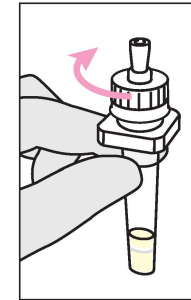

Firmly attach the nozzle provided in the kit to the top of the tube containing the prepared sample.

Sample Application

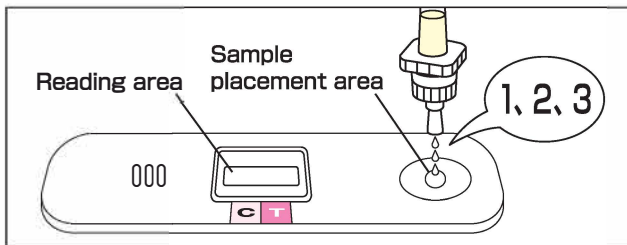

Hold the middle of the tube with the fingers and dispense 3 drops of the sample.

Caution

The test plate should be used immediately after opening the packaging.

Note

1. The mixed solution (extraction reagent) of Reagent 1 and 2 cannot be preserved. It should be used immediately after mixed.
2. Hold the tube perpendicularly and take care not to let the tip of the nozzle touch the sample placement area.
3. Regardless of the depth of color, any lines visually recognized in the reading area, are considered valid.
4. A line that appears anywhere within the section of the reading area, which separated by color, is considered valid.
5. If an excessive amount of the sample is dispensed, the reaction time may be prolonged due to the dilution of the colloidal platinum-gold labeled antibody based on the principle of the test, and no line may be seen at [C] and/or [T] in the reading area within the judgment time or the line is faint.
6. An inadequate standing time may result in the inadequate extraction of the antigens into the extraction reagent, which may lead to a false result.

Reading Result



Positive



Negative